

When Land Is More Important Than Money..

FARM LAND at Manneguda,
Chevella - Vikarabad Highway - 501102

Co-Ordinates: 17°19'22.9"N 77°59'12.3"E

www.silpa.co.in

A Project by : **Silpa Infratech Ltd.**
3rd floor, plot no: 57, phase-1, Kavuri hills, Hyd.-500 081

[f](#) [ig](#) [in](#) /silpagroup



Silpa
Aranya

ACRES OF **LAND.**
ACRES OF **OPPORTUNITY.**

FARM LAND at Manneguda,
Chevella - Vikarabad Highway - 501102

Take a step closer to nature🌿

Silpa Aranya is spread across 112 acres of beautiful landscape in a town named Manneguda, Chevella – Vikarabad Highway The sought after project consists of numerous and diverse Farm Land.

The Whole Project is organized systematically and provided with Electricity Connection and a HDPE water line to each plot along with drip. You can even have a holiday weekend here as we provide all the amenities too!

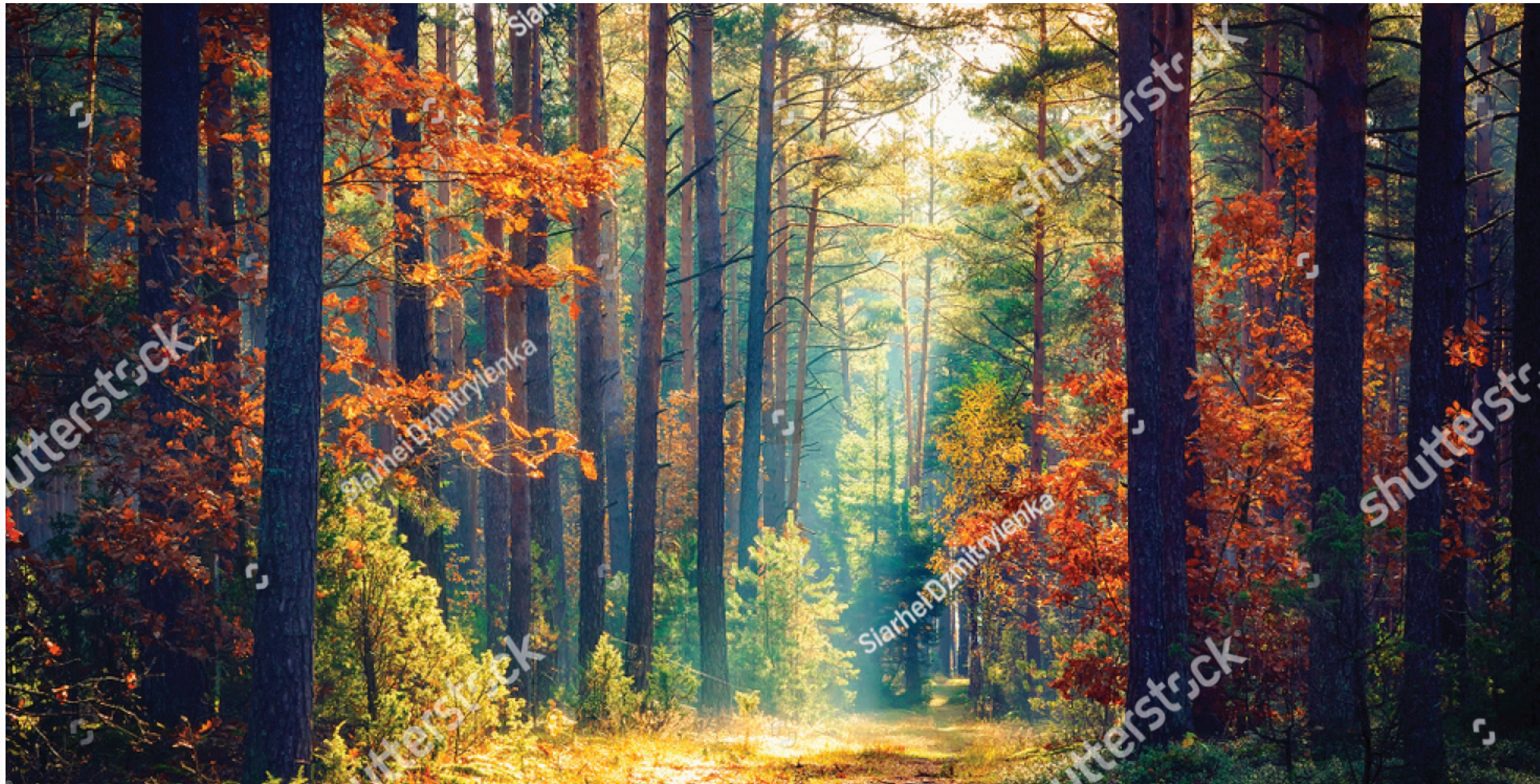

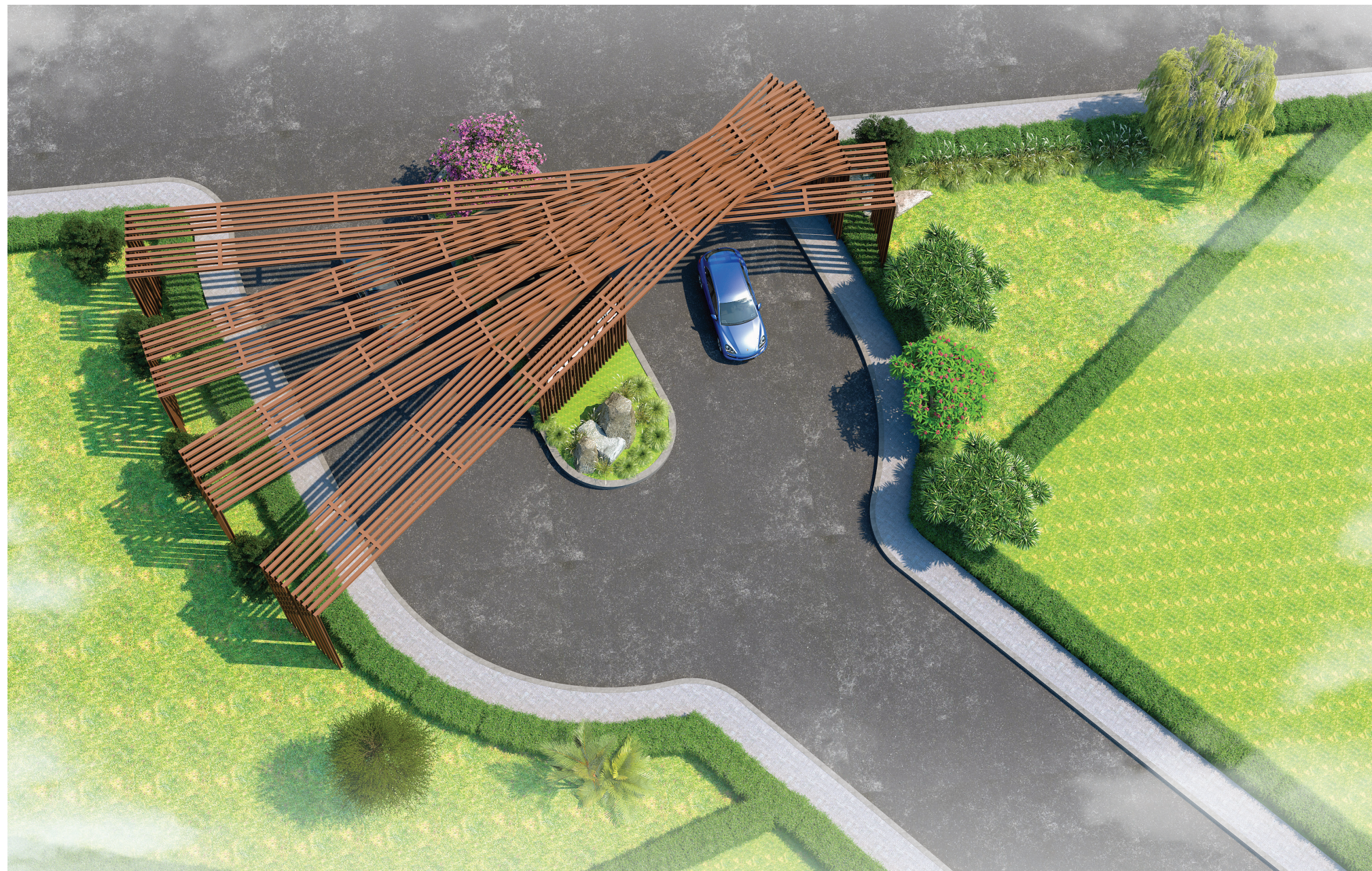

Developed, Organized and Good to go! 🌿

Never run out of options when you're on a pursuit of a goal. And here, we have provided you with all the important options and sustainable framework with the help of our experienced craftsman.

Layout Development:

- 🌿 All around Compound Wall
- 🌿 Grand Entrance Arch
- 🌿 Electricity Connection
- 🌿 HDPE Water line to Each Plot along with Drip
- 🌿 Internal Roads with gravel
- 🌿 Land Clearing and Levelling with Plot Stones
- 🌿 Over Head Tank with Sump
- 🌿 Street Lights
- 🌿 Main Road with top layer BT and Kerbstone and Saucer Drains.
- 🌿 Avenue Plantation
- 🌿 Beautifully Landscaped Gardens

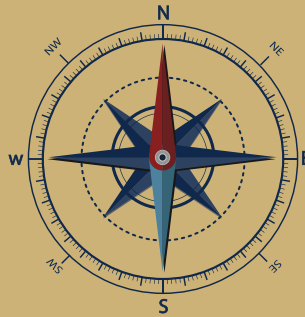

Here's 
The Master Plan.

FARM Plan

TOTAL AREA :
112 Acres

Silpa
Aranya

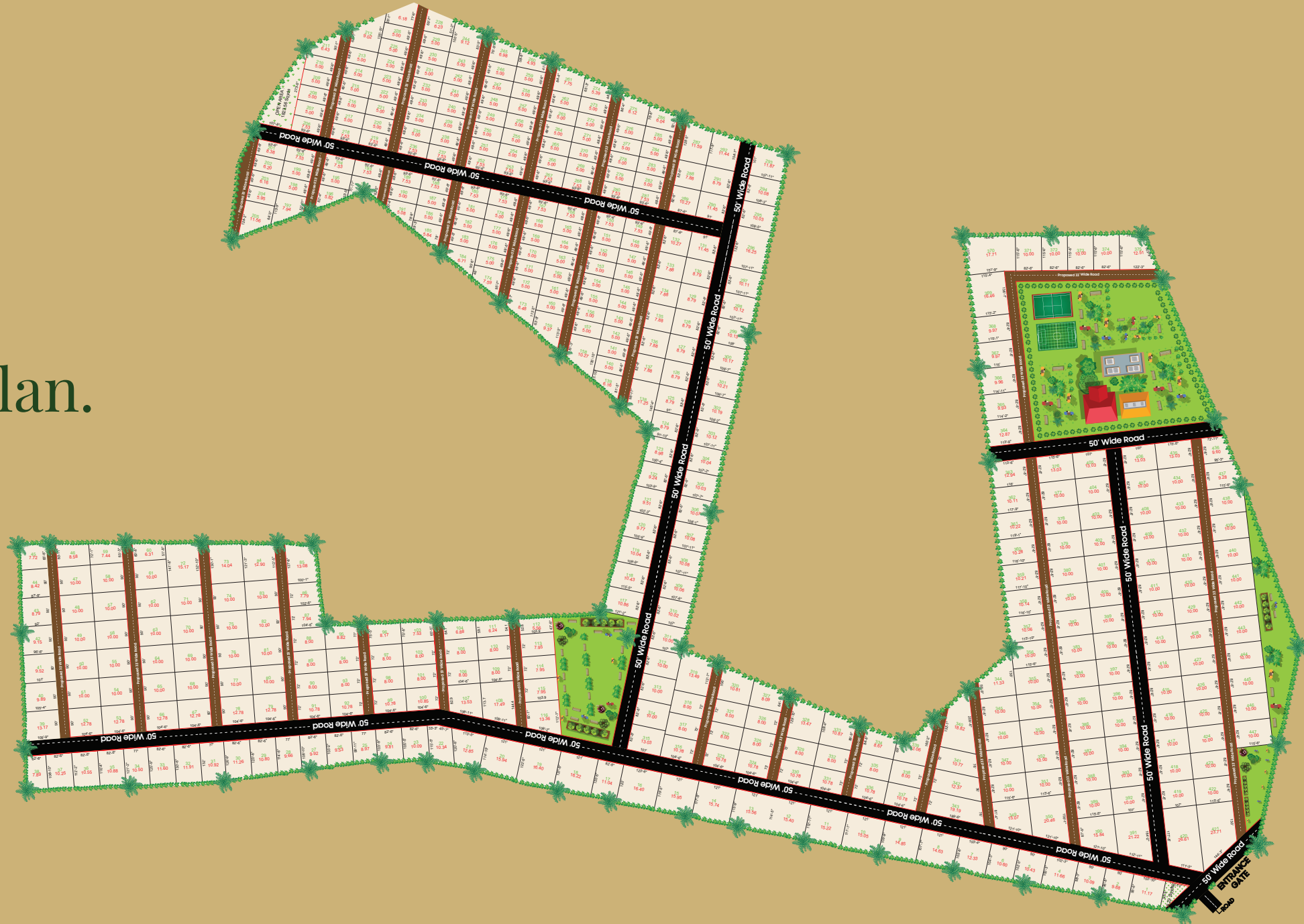

Area Table			Area Table			Area Table			Area Table			Area Table		
Farm Land No	Extent in Guntas	Facing	Farm Land No	Extent in Guntas	Facing	Farm Land No	Extent in Guntas	Facing	Plot No	Extent in Guntas	Facing	Plot No	Extent in Guntas	Facing
01	11.7	North	101	8	East	201	8.38	North-West	301	10.21	West	401	10	East
02	9.28	North	102	8	East	202	8.2	West	302	10.19	West	402	10	East
03	10.09	North	103	7.53	East	203	6.16	West	303	10.12	West	403	10	East
04	11.66	North	104	6.88	West	204	5.95	West	304	10.04	West	404	10	East
05	10.43	North	105	8	West	205	11.56	West	305	10.03	West	405	13.03	North-East
06	10.6	North	106	8	West	206	7.53	South-East	306	10.07	West	406	13.03	North-West
07	12.33	North	107	13.53	South-West	207	5	East	307	10.08	West	407	10	West
08	14.63	North	108	17.49	South-East	208	5	East	308	10.08	West	408	10	West
09	14.85	North	109	8	East	209	5	East	309	10.6	West	409	10	West
10	15.05	North	110	8	East	210	5	East	310	10.02	West	410	10	West
11	15.22	North	111	6.24	East	211	6.43	East	311	10	West	411	10	West
12	15.4	North	112	5.56	West	212	9.02	West	312	10	West	412	10	West
13	15.66	North	113	7.95	West	213	5	West	313	10	West	413	10	West
14	15.74	North	114	7.95	West	214	5	West	314	10	West	414	10	West
15	15.95	North	115	7.95	West	215	5	West	315	13.03	South-West	415	10	West
16	16.4	North	116	13.36	South-West	216	5	West	316	10.78	South-East	416	10	West
17	11.04	North	117	10.86	East	217	5	West	317	8	East	417	10	West
18	16.22	North	118	10.43	East	218	7.53	South-West	318	8	East	418	10	West
19	16.4	North	119	10.04	East	219	7.53	South-East	319	13.49	East	419	10	West
20	15.94	North	120	9.77	East	220	5	East	320	10.81	West	420	26.61	South-West
21	12.85	North	121	8.51	East	221	5	East	321	8	West	421	23.71	South-East
22	10.34	East	122	9.24	East	222	5	East	322	8	West	422	10	East
23	10.09	North	123	8.98	East	223	5	East	323	10.78	South-West	423	10	East
24	9.81	North	124	8.79	East	224	5	East	324	10.78	South-East	424	10	East
25	8.97	North	125	8.79	East	225	5	East	325	8	East	425	10	East
26	8.79	North	126	8.79	East	226	5	East	326	8	East	426	10	East
27	9.92	North	127	8.79	East	227	6.18	East	327	8.09	East	427	10	East
28	9.66	North	128	8.79	East	228	6.23	West	328	13.47	West	428	10	East
29	10.8	North	129	8.79	East	229	5	West	329	8	West	429	10	East
30	11.28	North	130	8.79	East	230	5	West	330	10.78	South-West	430	10	East
31	10.92	North	131	11.45	North-East	231	5	West	331	10.78	South-East	431	10	East
32	11.91	North	132	10.27	North-West	232	5	West	332	8	East	432	10	East
33	7.88	West	133	7.88	West	233	5	West	333	10.87	East	433	10	East
34	10.5	North	134	7.88	West	234	5	West	334	8.67	West	434	10	East
35	10.88	North	135	7.88	West	235	5	West	335	8	West	435	13.03	North-East
36	10.65	North	136	7.88	West	236	7.53	South-West	336	10.78	South-West	436	9.6	West
37	10.25	North	137	7.88	West	237	7.53	South-East	337	9.28	South-East	437	9.28	West
38	7.99	North	138	11.25	West	238	5	East	338	8	East	438	10	West
39	13.17	South-East	139	6.16	East	239	5	East	339	12.06	East	439	10	West
40	9.89	East	140	5	East	240	5	East	340	18.52	East - West	440	10	West
41	9.52	East	141	5	East	241	5	East	341	10.77	East - West	441	10	West
42	9.15	East	142	5	East	242	5	East	342	12.37	East - West	442	10	West
43	8.79	East	143	5	East	243	5	East	343	19.19	East - West	443	10	West
44	8.42	East	144	5	East	244	9.12	East	344	11.33	West	444	10	West
45	7.72	East	145	5	East	245	6.98	West	345	10	West	445	10	West
46	8.58	West	146	5	East	246	5	West	346	10	West	446	10	West
47	10	West	147	5	East	247	5	West	347	10	West	447	10	West
48	10	West	148	5	East	248	5	West	348	10	West			
49	10	West	149	7.53	North-East	249	5	West	349	15.07	South-West			
50	10	West	150	7.53	North-West	250	5	West	350	20.46	South-East			
51	10	West	151	5	West	251	5	West	351	10	East			
52	12.78	South-West	152	5	West	252	7.53	South-West	352	10	East			
53	12.78	South-East	153	5	West	253	7.53	South-East	353	10	East			
54	10	East	154	5	West	254	5	East	354	10	East			
55	10	East	155	5	West	255	5	East	355	10	East			
56	10	East	156	5	West	256	5	East	356	10	East			
57	10	East	157	5	West	257	5	East	357	10.06	East			
58	10	East	158	10.27	West	258	5	East	358	10.14	East			
59	7.44	East	159	9.37	East	259	5	East	359	10.21	East			
60	6.31	West	160	5	East	260	4.93	East	360	10.23	East			
61	10	West	161	5	East	261	7.75	West	361	10.22	East			
62	10	West	162	5	East	262	5	West	362	10.11	East			
63	10	West	163	5	East	263	5	West	363	12.94	North-East			
64	10	West	164	5	East	264	5	West	364	12.67	South-East			
65	10	West	165	5	East	265	5	West	365	9.93	East			
66	12.78	South-West	166	7.53	North-East	266	5	West	366	9.96	East			
67	12.78	South-East	167	7.53	North-West	267	7.53	South-West	367	9.97	East			
68	10	East	168	5	West	268	7.53	South-East	368	9.97	East			
69	10	East	169	5	West	269	5	East	369	16.46	East			
70	10	East	170	5	West	270	5	East	370	17.71	West			
71	10	East	171	5	West	271	5	East	371	10	West			
72	15.17	East	172	5	West	272	5	East	372	10	West			
73	14.04	West	173	8.48	East	273	5	East	373	10	West			
74	10	West	174	7.59	East	274	5.39	East	374	10	West			
75	10	West	175	5	East	275	8.12	West	375	12.51	West			
76	10	West	176	5	East	276	5	West	376	13.03	North-West			
77	10	West	177	5	East	277	5	West	377	10	West			
78	12.78	South-West	178	5	East	278	5	West	378	10	West			
79	12.78	South-East	179	7.53	North-East	279	5	West	379	10	West			
80	10	East	180	7.53	South-West	280	7.53	South-West	380	10	West			
81	10	East	181	5	West	281	7.53	South-East	381	10	West			
82	10	East	182	5	West	282	5	East	382	10	West			
83	10	East	183	5	West	283	5	East	383	10	West			
84	12.9	East	184	6.71	West	284	5	East	384	10	West			
85	13.08	West	185	5.84	East	285	5	East	385	10	West			
86	7.79	West	186	5	East	286	6.04	East	386	10	West			
87	7.94	West	187	5	East	287	5	West	387	10	West			
88	8	West	188	7.53	North-East	288	7.88	West	388	10	West			
89	8	West	189	7.53	North-West	289	10.27	South-West	389	10	West			
90	8	West	190	5	West	290	11.45	South-East	390	15.54	South-West			
91	10.79	South-West	191	5.08	West	291	8.79	East	391	21.22	South-East			
92	10.78	South-East	192	5.64	East	292	11.44	East	392	10	East			
93	8	East	193	7.53	North-East	293	11.87	West	393	10	East			
94	8	East	194	7.53	North-West	294	10.08	West	394	10	East			
95	8.82	East	195	5	West	295	10.3	West	395	10	East			
96	8.17	West	196	5.82	West	296	16.25	West	396	10	East			
97	8	West	197	7.94	East	297	10.11	West	397	10	East			
98	8	West	198	5	East	298	10.12	West	398	10	East			
99	10.78	South-West	199	5	East	299	10.13	West	399	10	East			
100	10.85	South-East	200	7.53	North-East	300	10.17	West	400	10	East			



Where it all matters

The picturesque green landscapes provide us with rich, fertile & expansive soil to grow a wide variety of plants. A systematic network of constant water supply and electricity is built to ensure there's no shortage of resources to grow lushy plants.

Plantation List for Each Plot:

- | | | |
|-----------------|-----------------------|-----------------------------|
| ● Anjeer | ● Coconut | ● Mango (Different Variety) |
| ● Amla | ● Kala Jamun (Neredu) | ● Papayya |
| ● Custard Apple | ● Jack Fruit (Panasa) | ● Pomegranate |
| ● Avocado | ● Sweet Lime | ● Dragon fruit |

Connected to the Creation?

Don't feel like returning to your home? Take a break and enjoy your relaxing association with nature! Spend some time with your family and friends to make your trip all the more enjoyable and memorable!

Project Amenities:

- 15,000 Sft Club House with Swimming Pool
- SPA
- Restaurant
- Gymnasium
- Multipurpose Hall
- Association Office
- Indoor Games
- Outdoor Games and Children's Play Area
- Guest Rooms
- 24/7 Security
- CC Cameras at selected points



Give your body
a holiday 
bonus at the SPA



It's time for 
a delightful meal
at the Restaurant.



Nothing beats
breakfast at
the pool 

15,000 Sq ft **Club House** with
Swimming Pool On a rooftop!



A Gymnasium 
for the wild ones!

